

# 2904 AA

## House of Arts and Culture Beirut

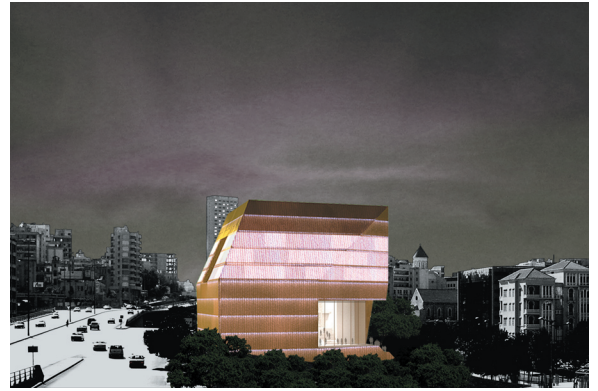

### 01\_Site

The House of Arts and Culture will be taking up a key role as an urban catalyst for the development of downtown Beirut and its connection to adjoining parts of town. It's landmark setting on the edge of the ring road as a major traffic route will mark an entrance into the newly developed downtown of Beirut. The House of Arts and Culture with its characteristic and open façade with big urban windows understands the ring road not as an obstacle but as an opportunity to communicate its use and function not only to its immediate surrounding but to the whole city of Beirut.

The building uses 70% of the building site, of which the shape of the building has been designed according to the zoning laws of the plot. Being located close to the ring road the building allows for a maximum surface of open public space on the northern edge of the plot, facing the downtown district. The landscaped public space in front of the building is a first location for happenings to take place in connection with House of Art and Culture. One of the main ideas of the design proposal deals with the issue of continuing this open public space into the building.

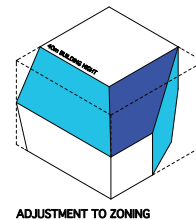
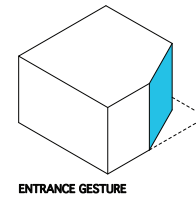
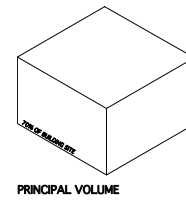

## 02\_Public Space

The House of Arts and Culture will be a vibrant point in the cultural landscape of Beirut housing all kinds of different cultural activities, such as exhibitions, plays and screenings, as well as media productions. It will also hold an archive for media of contemporary and classic culture. Those cultural activities will be scattered throughout the whole building, and the proposal seeks to link all these activities on one main public route that at the same time acts as the main circulation.

The public circulation is connecting all floors of the building, passing by 3 large foyers and finally leading up to a roof garden with views to the sky and across town. The 3 foyers act as public spaces inside the building and are holding entrances to all main cultural activities within the House of Arts and Culture, as well as being places for exhibitions, to meet, and to have a coffee. Each foyer is characterised by a big urban window looking out into different directions, so visitors are not only travelling through the building, but also through the skyline of Beirut. The foyers open up to all 4 sides of the building, being at the same time spatially connected which is allowing spectacular views from almost top to bottom.

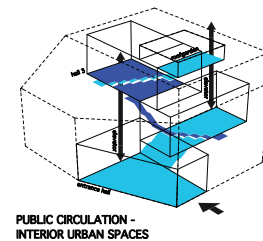

## 03\_Programme

The big performance hall and the exhibition rooms are the key elements for the organisation of the building. The big performance hall is located on the ground floor. To allow for its flexibility in use, it can be accessed from different levels, of which the main entrance is located on 2nd floor. This design allows for both convenient access for visitors and the delivery of stage settings and stagecraft.

The exhibition hall is located on the top floor of the House of Arts and Culture, so optimal light conditions can be achieved by roof lights to exhibit contemporary and classic art.

All functions can be easily reached from the continuous public route through the building, at the same time individual opening hours are made possible. Alternatively, for night hours, they can be made independent from the major

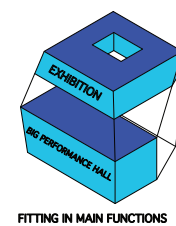

functions. 2 elevator shafts connect to all parts of the building. The large freight elevator directly links the delivery with the exhibition rooms on the top floor of the building.

#### 04\_Construction, Material and Facades

The House of Arts and Culture is envisioned as a concrete construction. This construction type corresponds to the compact layout of the building and the intention of incorporating large openings in the facades.

The facades are characterized by a second skin, a light and transparent metal screen that also acts as a sun screen for secondary windows that lie behind it.

All walls lining the continuous public route are made of washed and polished concrete with a light stain. White concrete allows for flexible use, projections and the fixture of artworks and media interfaces. Handrails, stairs and main doors will be made of wood and brass to refer back to the outside of the building.

#### 06\_Climatic

The House of Arts and Culture is designed as a green building. It was developed with the intention of maximum of natural climatisation.

A ventilation concept is based on the continuous public space within the building. The air will be circulating through the building via the three large foyers, acting as natural ducts. The openings will help to draw air and so help the ventilation process. The roof garden allows the raising air to escape, leaving the building with a natural and comfortable climate.

The 'stepped' external façade is allowing for natural ventilation for all further contained rooms. External air is drawn in and filtered and the intake can be individually regulated for user comfort. Used air is released into internal shafts to rise upwards and out. Furthermore the House of Arts and Culture will have an integrated automated system which opens internal windows in building during night time (1am-6am) to cool down the internal space, when needed.

